

Remote Emergency Pack for LED Luminaires

EMPACK 001

Installation :



Fig.2

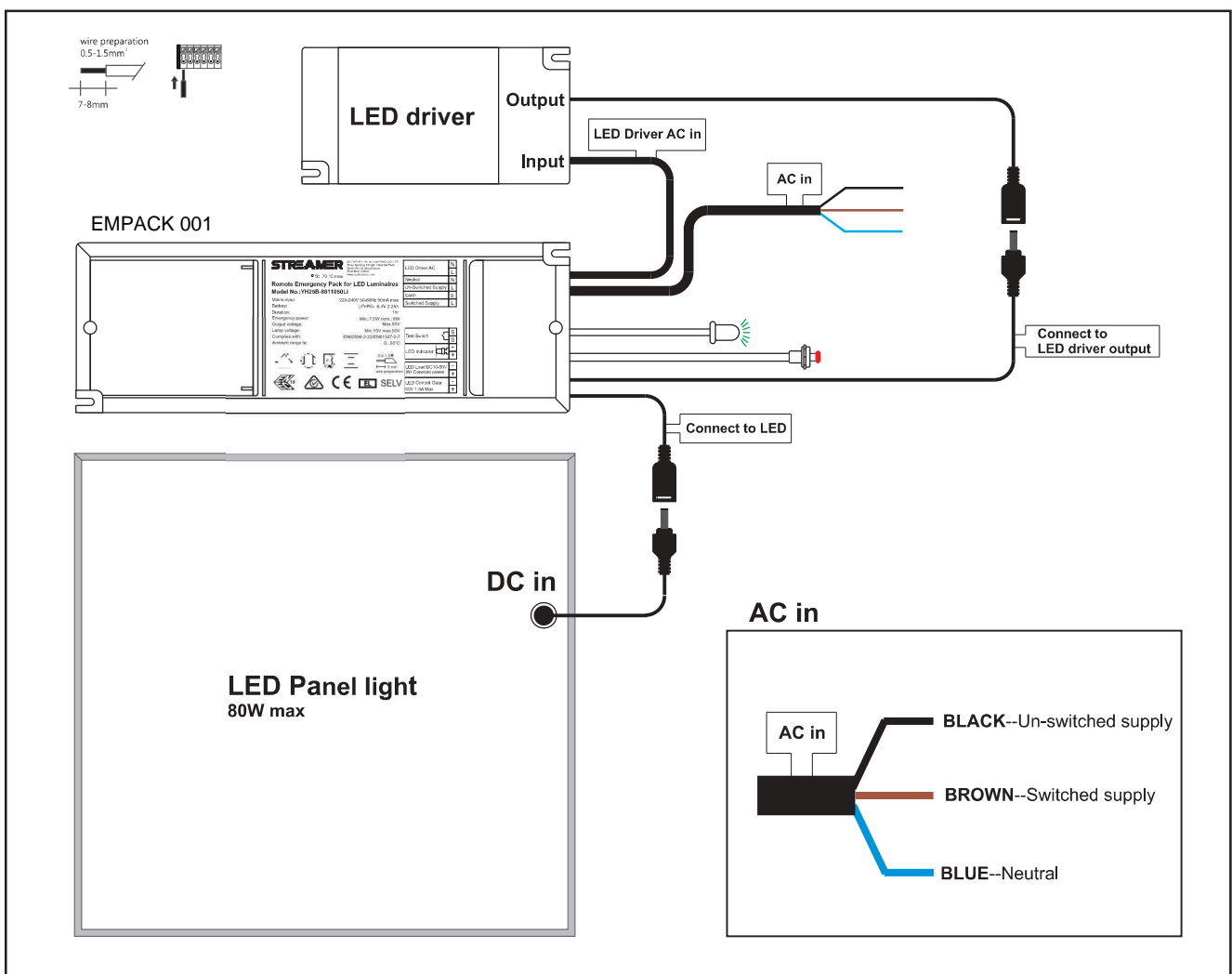

Fig.3

Fig.2 -The driver could be installed on the back of LED panels.

Fig.3 -There is a battery box in the driver, where users could replace the battery pack . But users have to use our battery pack modules.

Wiring diagram(Maintained)



Remote Emergency Pack for LED Luminaires

EMPACK 001

Notes :

Please do not cover this control gear .



Warranty

- Warranty 3 years
- Except for the following circumstances:
 - 1) Improper installation or operation.
 - 2) Misuse.
 - 3) Abuse.
 - 4) Unauthorized or improper repair alteration.
 - 5) Accident or negligence in use, storage, transportation.
 - 6) Any natural acts.

* If users would like to change the batteries pack, please use the nominated models of STREAMER , then it will be under the warranty .